

For installation of Quarter 2 wall washer.  
Model. U31351-U31362 , U31371-U31375 and U31381-U31383.

**Product drawing (dimensions) SUITABLE FOR WET LOCATIONS**

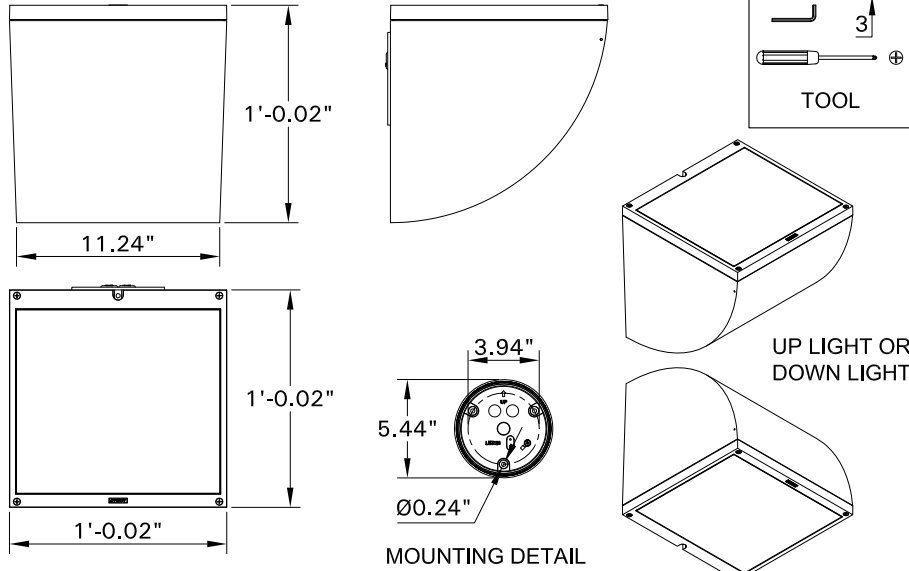

**NOTE**  
Mounts over  
a 3"Octagonal  
Junction box.

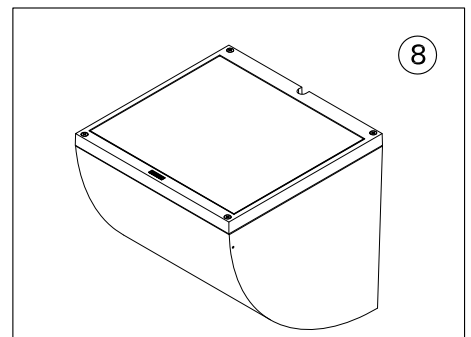
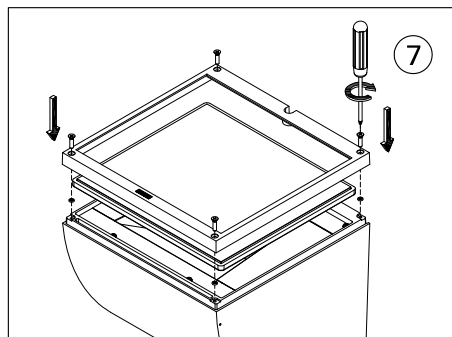
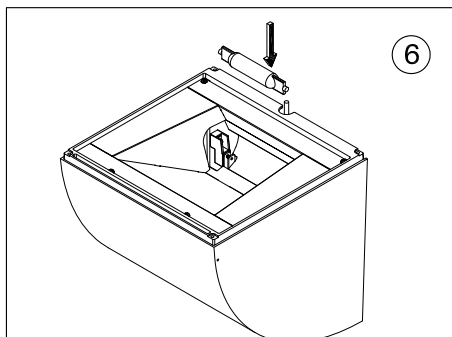
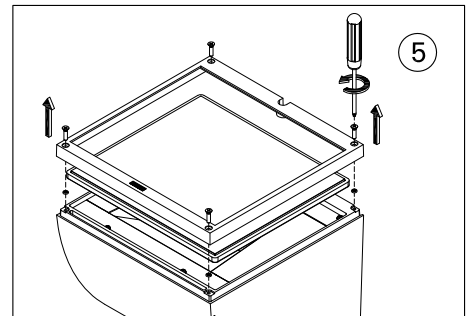
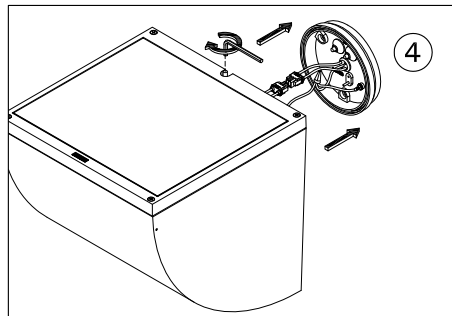
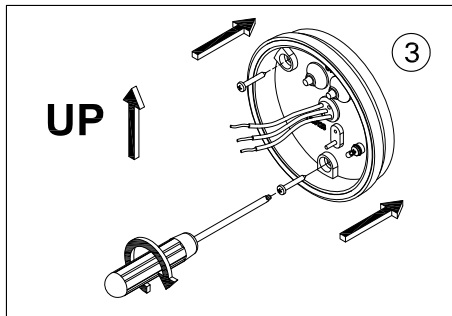
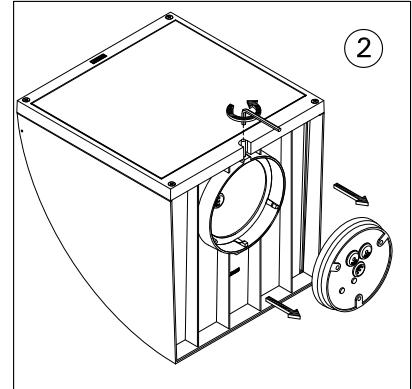
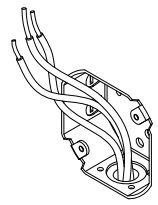

**Notice to installer :**

- 1.WIRING INSTRUCTIONS** Warning : RISK OF FIRE AND ELECTRICAL SHOCK. : FIXTURE MUST BE INSTALLED BY A QUALIFIED ELECTRICIAN ONLY>FIXTURE IS INTENDED FOR INSTALLATION IN ACCORDANCE WITH THE NATIONAL ELECTRICAL CODE, LOCAL AND FEDERAL CODE SPECIFICATIONS. DISCONNECT POWER BEFORE SERVICING.
- 2.This fixture has a VOLTAGE SPECIFIC BALLAST,Check that the supply voltage is the same as the installed ballast voltage.**

**Ligman Lighting USA**

Tanasbourne Commerce Center  
3302 Nw 211th Terrace  
Hillsboro Oregon 97124  
Tel : 503-645-0500, Fax : 503-645-8100

[www.ligmanlightingusa.com](http://www.ligmanlightingusa.com)

U 31351/03/12/11/REV.0  
1/1



FM-TS-13/25-05-2007-REV.2